



Chester Hills



Welcome to

The Vilasya, Kufri

"LUXURY LIVING IN THE LAP OF NATURE"



A C T U A L I M A G E F R O M S I T E

About The Vilasya

The Vilasya is a sanctuary where nature seamlessly blends with luxury, offering an exceptional living experience in Kufri's picturesque hills. Designed to merge modern elegance with the serene Himalayas, it stands as more than just a residential project—it's a premier lifestyle destination.

Our dedicated team of architects and designers meticulously crafts each villa to embody sophistication, functionality, and sustainability. From spacious interiors to stunning views, every detail is thoughtfully planned to ensure residents enjoy a perfect harmony of comfort and nature.

The Vilasya blends eco-conscious living with luxurious amenities, offering a serene retreat that enhances your lifestyle while preserving nature. Experience timeless design and refined living in perfect harmony with the environment.



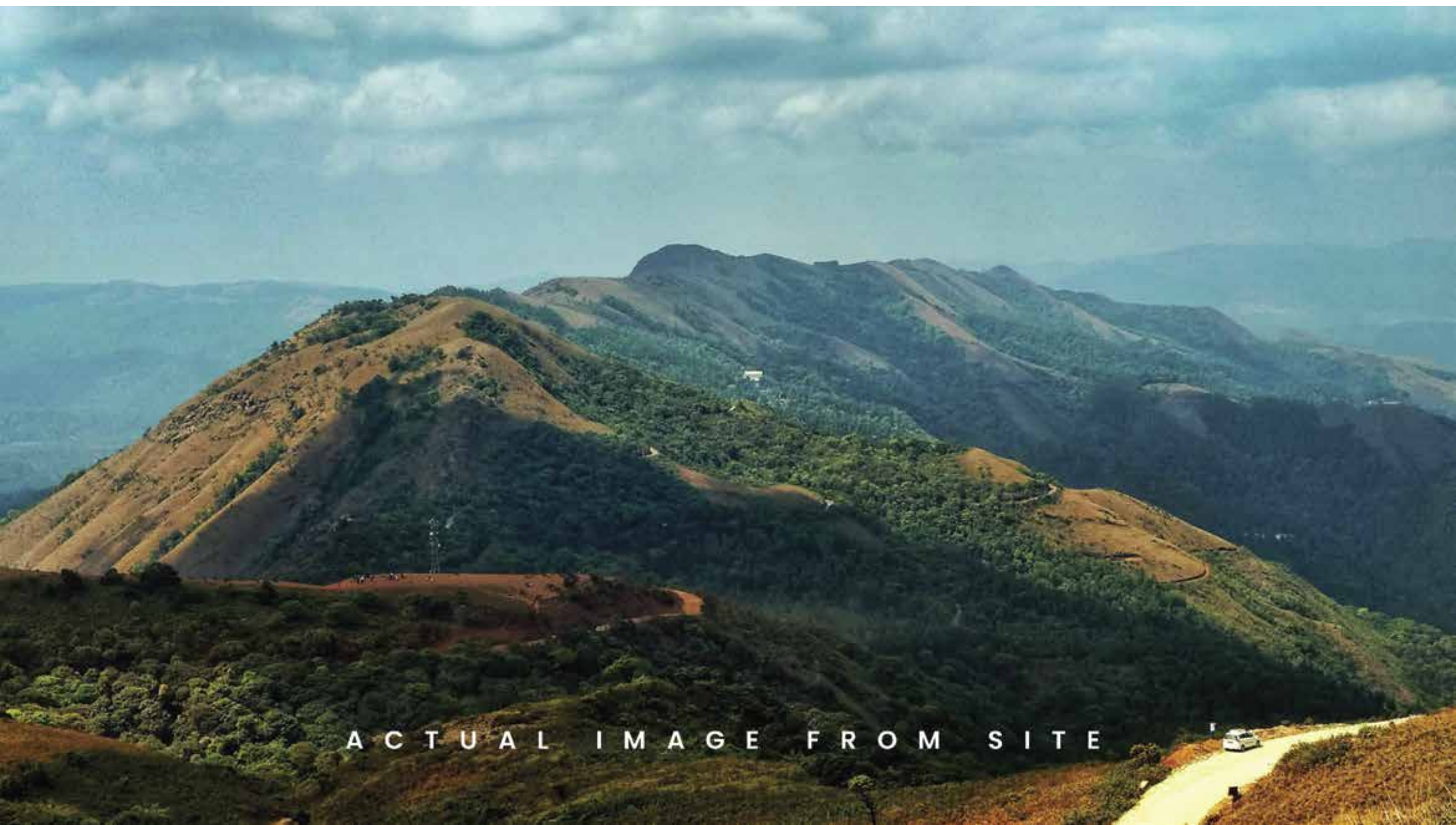

ACTUAL IMAGE FROM SITE

A Legacy of Excellence

A Legacy of Excellence and Craftsmanship

The Vilasya embodies the art of refined living, blending architectural brilliance with Kufri's natural beauty. Thoughtfully crafted, each villa balances elegance and functionality, offering expansive layouts, premium materials and seamless designs for a truly extraordinary lifestyle.

Rooted in sustainability, The Vilasya integrates eco-friendly practices and energy-efficient technologies to minimize environmental impact while maximizing luxury. More than a home, it is a timeless masterpiece that harmonizes modern living with nature's serenity, creating a legacy of elegance and comfort.

Excellence and



Site Plan

1. Entrance Plaza
2. Club House
3. Pool & Yoga Deck
4. Lawn Tennis Court
5. Cluster Parking
6. Villa Arrival Plaza
7. STP (Green Roof)
8. Transformer Yard
9. Water Tank

- Villa/Villaments
- Villa (400sqyd & 500sqyd)
- Club House



Schematic Villa

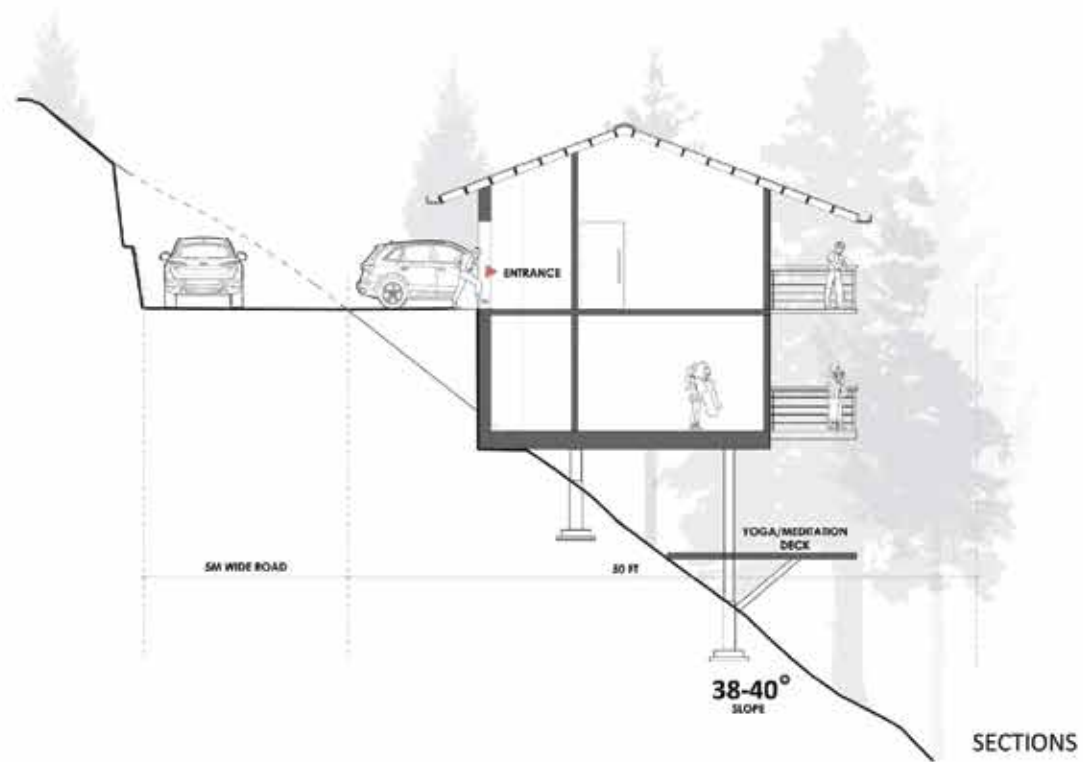



Club Amenities

- Gym
- Yoga/Meditation Deck
- Indoor/Outdoor Play Area
- Multi Cuisine Dining
- Spa with Steam
- Temperature Controlled Swimming
- Pool/Jacuzzi
- Staff Dormitory





ACTUAL IMAGE FROM SITE



Reference Image



Reference Image





Reference Image



Reference Image

3BHK Villa

300 Sqyd Plot

Ground Floor Area - 1175 sqft
Lower Ground Floor - 1121 sqf

Total Area - 2296 sqft

U P P E R G R O U N D F L O O R





3BHK Villa

300 Sqyd Plot

Ground Floor Area - 1175 sqft

Lower Ground Floor - 1121 sqf

Total Area - 2296 sqft

L O W E R G R O U N D F L O O R

Lower Ground Area - 790 sqf
Ground Floor Area - 958 sqft

UPPER GROUND FLOOR





LOWER GROUND

3BHK Villa

200 Sqyd Plot

Lower Ground Area - 790 sqf

Ground Floor Area - 958 sqft

Total Floor Area - 1748 sqft

L O W E R G R O U N D F L O O R

2BHK Villament 1250 Sqft



PADMA



1BHK Villament 850 Sqft



Reference Image





Interior View



Balcony Reference



Reference Image



Reference Image



Shimla Airport: 34 km
AIMSS Chamiana Hospital: 13 km
Shimla Railway Station: 16 km
Chail: 30 km
Delhi: 350 km
Chandigarh: 120 km
Chandigarh Airport: 130 km
Chandigarh Railway Station: 120 km
Shimla Water Catchment: 7.5 km
Wildflower Hall: 4 km
Shimla Maal Road: 14 km

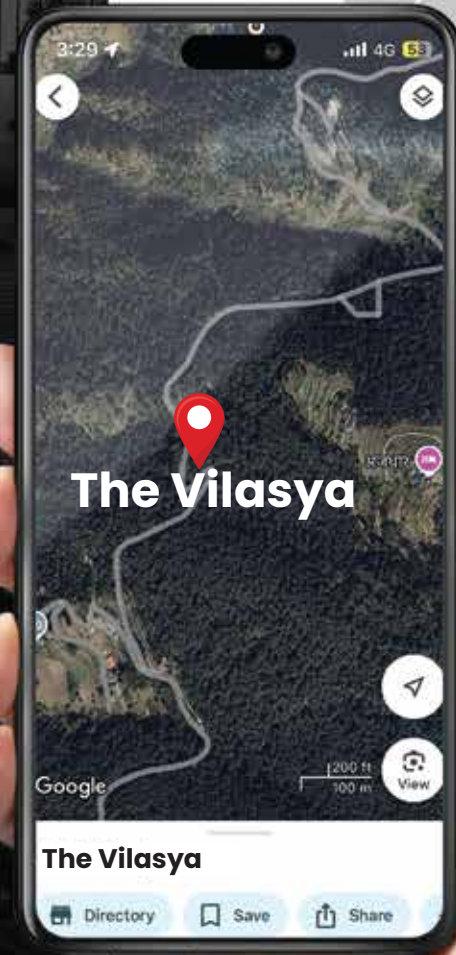

A scenic view of a mountain valley. In the foreground, a river flows through a rocky bed, surrounded by dense evergreen forests on steep slopes. In the background, snow-capped mountain peaks rise above a layer of mist or low clouds. The overall atmosphere is serene and majestic.

The Vilasya Awaits You – Your Dream Home in the Heart of Nature

**DON'T MISS THIS EXCLUSIVE OPPORTUNITY! SCHEDULE YOUR PRIVATE TOUR
TODAY AND EXPERIENCE THE CHARM OF THE VILASYA FIRSTHAND.**